

GENESISCARE
Campbelltown



FINAL ISSUE | February 2024

erilyan

Overview



Located on the corner of Kellicar Road and Camden Road, the project involved the construction of a four-story Comprehensive Cancer Centre operated by GenesisCare. The completion of the facility will provide treatment to both Public and Private patients offering radiation & medical oncology, clinical trials, pathology, and diagnostic imaging with complimentary services. The project is aiming to achieve (post completion) a 6-star Greenstar rating, utilising sustainable materials and practices throughout the construction process.

Project Milestones:

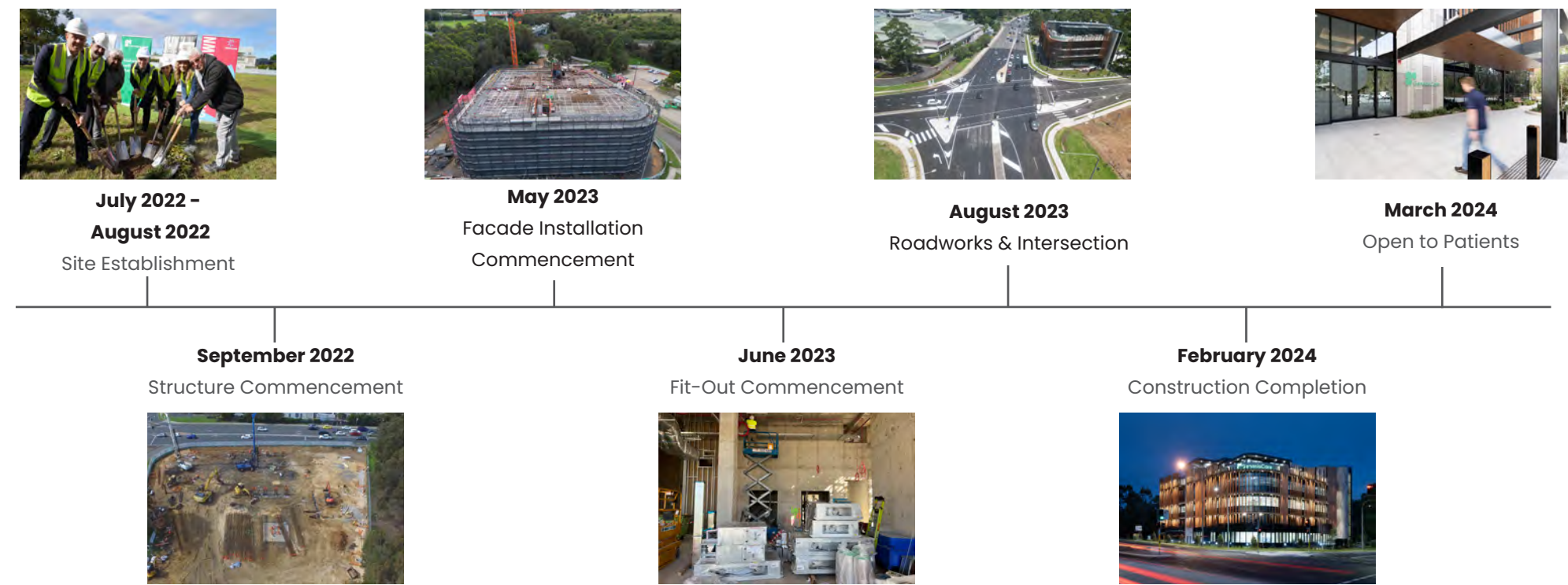



Project Update

The Erilyan team are thrilled to announce the completion of the GenesisCare Campbelltown, having now reached practical completion. The building has now been handed over to GenesisCare whom will now commence operations.

The final month of the project has been one full of milestones. The intersection and Camden Road work reached final completion, including the surrounding new footpaths and pedestrian islands. Externally we were finally able to unveil the building, removing all the temporary fencing to show off the beautiful, mainly native landscaping and the striking façade. Our EV charging bays were commissioned and the building given a full clean from top to bottom.

Internally the team were occupied with final commissioning and adjustments to the building systems, ensuring that the building will achieve the sustainability objectives. Excitingly, the building reached an incredible air tightness result to ensure that this development uses as little resources as possible. Erilyan will continue to compile the required data from the building over the coming months and aim to be submitting to the Green Building Council to achieve a Greenstar Rating for the project.

Erilyan is incredibly proud of the project and what has been able to be delivered in conjunction with the project stakeholders, to serve the Macarthur community and wider catchment.



Message from the Site Manager – Ryan Kenny

“Typically, the significant memories of a project revolve around construction milestones like the first installation of temporary fencing, the initial major concrete pour, setting up the tower crane, or revealing a stunning facade after removing scaffolding. However, one of the most significant highlights of this project will be the impact it has on people’s lives.

I’d like to thank the stakeholders, the subcontractors, the consultants and most of all our team for the passion they’ve invested into this project. Every visit from Campbelltown Council, Campbelltown Library, and our clients during construction was met with genuine interest and appreciation for our hard work.

Each member of the GCC team has experienced significant growth and will carry forward valuable lessons and knowledge into future projects.”

Message from the Project Manager – Cale Holmes

“Delivering the GenesisCare Campbelltown has been a truly gratifying and unique experience. Not only were we an integral part of constructing a World Class Cancer Treatment Facility, but we were also afforded the privilege of playing our part in launching the revitalisation of an entire community. For this we are all very grateful and I would personally like to thank Campbelltown City Council, GenesisCare and Northwest Health Properties for this opportunity.

Finally, I extend a very heartfelt thank you to each member of our team, our subcontractors, and our consultants. This building is a true reflection of the hard work and dedication put in by everyone and it’s a project we should all be immensely proud of!”





External Building & Carpark

Thermal & Acoustic qualities of the facade:

- Laminated double glazed units provide some of the highest acoustic and Thermal performance in Australia (just short of triple glazing)





Level 1 Oncology & Level 1 Waiting Area

- Approximately 36 separate concrete pours
- Over 1500 separate workers were inducted into the project
- Over 220,000 working hours logged for the project.



Level 3 Terrace & Wellness Pavillion

Airtightness ceiling in Wellness Pavillion – Linked to overall airtightness score:

- The project received an Airtightness of $3.8\text{m}^3/\text{m}^2/\text{hour}$ air change – an average high performing building achieves approx. $20\text{m}^3/\text{m}^2/\text{hour}$ air change, so our building is over 5 times more airtight.





Design Excellence

- 20kL Rainwater recapture tank services toilets and irrigation for the entire project
- Use of MegaVault in the carpark to ensure tree growth to provide maximum shading to the carpark as the trees mature
- Solar capacity - 39KW solar array
- EcoPack Concrete - 2800m3 of ecopact concrete used - this reduces approximately 140,000kg of carbon reduction over conventional concrete.

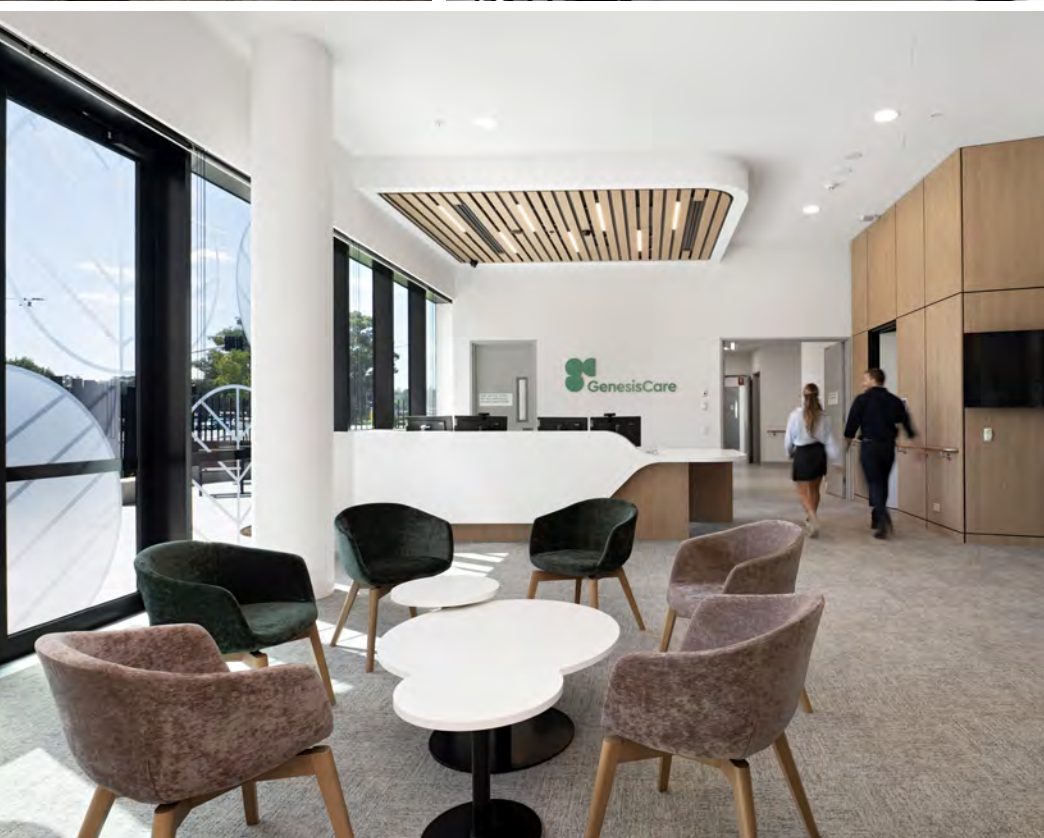



Erilyan Group Pty Ltd

Phone: 02 8188 0700
Email: info@erilyan.com.au Website:
www.erilyan.com.au ABN: 16 664 334
767

NSW

1/27 Hotham Parade,
Artarmon
NSW 2064

VIC

Unit 2/200 Toorak Rd,
South Yarra
VIC 3141